

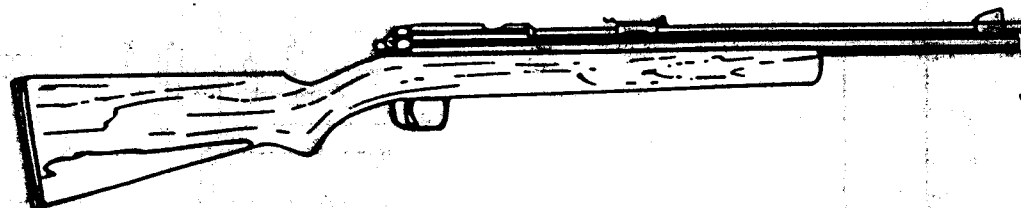

EXPLODED VIEW, PARTS AND PRICE LIST

MODEL
G397 / G392 / FB9
GS397 / GS392 / F9



This parts and price list is intended to be an informational guide in ordering Benjamin Sheridan parts. It is not instructional material and we therefore assume no responsibility for those use who use same without proper factory training.

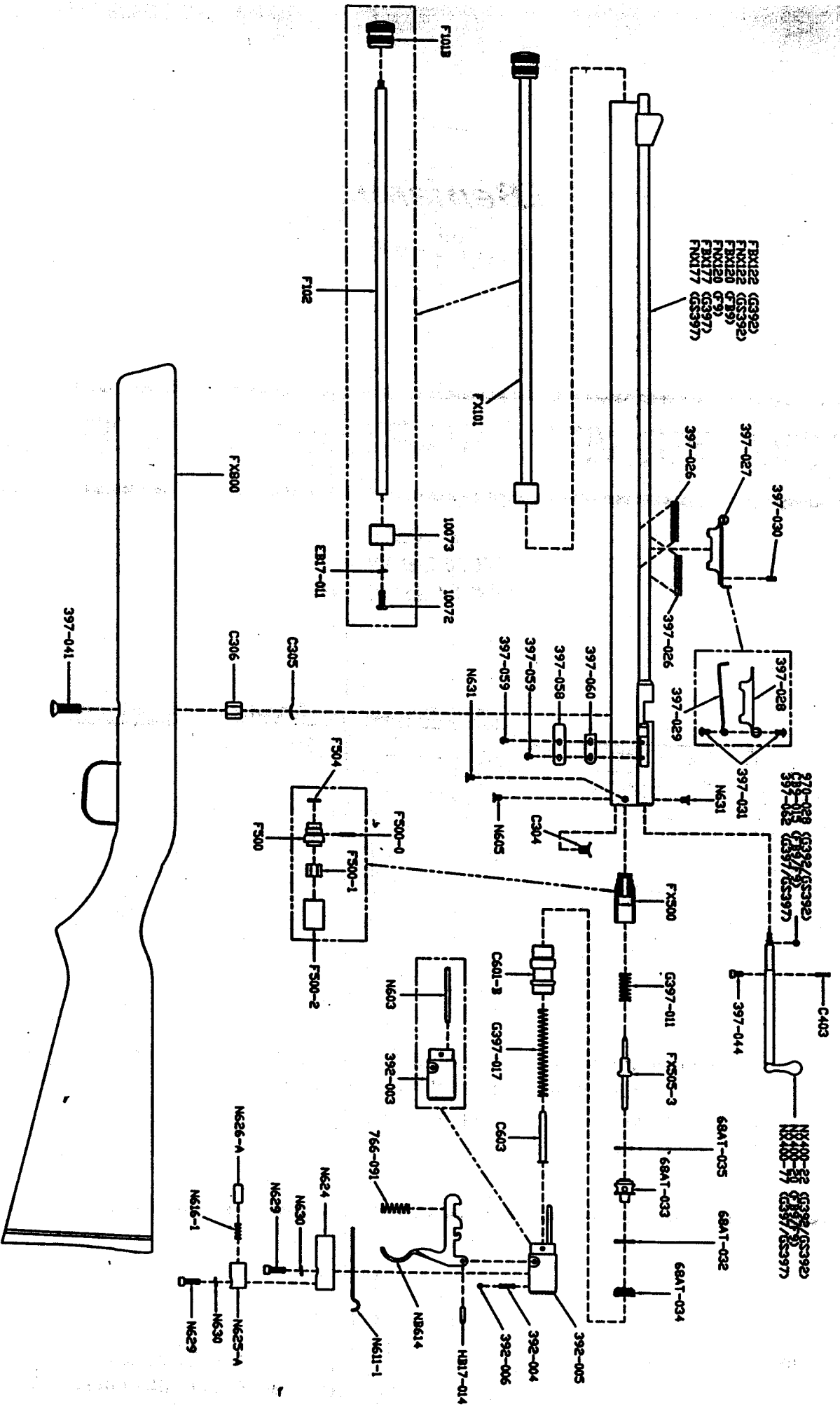

FBX132 (G3992)
 FBX132 (G3992)
 FBX132 (G3992)
 FBX132 (G3992)
 FBX132 (G3992)
 FBX132 (G3992)
 FBX132 (G3992)

397-028 (G3992/G3992)
 397-028 (G3992/G3992)
 397-028 (G3992/G3992)

68AT-035
 68AT-032

68AT-033
 68AT-034

392-005
 392-004
 392-006
 NB614
 HB17-014

N624
 N630
 N629
 N625-A
 N630
 N629

239004
CB7 MODELS
G397 G392/FB9
GS397 GS392/F9
PARTS AND PRICE LIST
NON - CARTRIDGE VALVE

<u>PART NUMBER</u>	<u>QTY PER</u>	<u>PART NAME</u>	<u>COST</u>	
10072	1	FILLER CAP SCREW	\$.50	
10073	1	FILLER HEAD	*	
392-003	1	RETAINING CAP	\$12.52	
392-004	1	SAFETY SPRING	\$.50	
392-005	1	RETAINING CAP ASS'Y	\$13.23	
392-006	1	SAFETY BALL	\$.50	
397-026	2	BASE GRIP	\$.50	
397-027	1	REAR SIGHT ASS'Y	\$5.44	each
397-028	1	SIGHT ARM	\$1.55	
397-029	1	SIGHT BASE	\$2.84	
397-030	1	ELEVATION SCREW	\$.50	
397-031	2	WINDAGE SCREW	\$.50	each
397-041	1	RECEIVER/STOCK SCREW	\$.50	
397-044	1	BOLT LOCKING LUG	\$.50	
397-058	1	CAM FACE COVER	\$.77	
397-059	2	CAM FACE SCREW	\$.50	each
397-060	1	CAM FACE	\$.50	
397-062	1	BOLT SEAL (G397, GS397)	\$.50	
68AT-032	1	LEAD VALVE GUIDE GASKET	\$.50	
68AT-033	1	VALVE GUIDE	\$11.05	
68AT-034	1	VALVE GUIDE RETAINER NUT	\$1.34	
68AT-035	1	VALVE GUIDE GASKET	\$.50	
766-091	1	SEAR SPRING	\$.50	
970-028	1	BOLT SEAL (G392, GS392)	\$.50	
G304	1	ACTION FASTENER SCREW	\$1.05	
C305	1	ACTION FASTENER WASHER	\$.50	
C306	1	ACTION FASTENER NUT	\$.65	
C403	1	BOLT BODY SPRING	\$.50	
C601-B	1	STRIKER	\$5.82	
C603	1	GUIDE PIN	\$.50	
GB9-015	1	BOLT SEAL (FB9, F9)	\$.50	
EB17-011	1	LOCK WASHER	\$.50	
F101B	1	FILLER CAP(see G397-002)	*	
F102	1	FILLER ROD	*	
F500	1	CHAMBER PLUG	\$1.94	
F500-0	1	OORING	\$.50	
F500-1	1	CHAMBER PLUG SLEEVE	\$.50	
F500-2	1	CHAMBER SLEEVE	\$.50	
F504	1	CHAMBER PLUG FACE(see G397-012)	*	
FBX120	1	TUBE ASS'Y (FB9)	\$106.92	
FBX122	1	TUBE ASS'Y (G392)	\$103.62	
FBX177	1	TUBE ASS'Y (G397)	\$105.45	

MODELS
G397, G392, FB9
GS397, GS392, F9
PARTS AND PRICE LIST
NON-CARTRIDGE VALVE

<u>PART NUMBER</u>	<u>QTY PER</u>	<u>PART NAME</u>	<u>COST</u>
FNX120	1	TUBE ASS'Y (F9)	\$81.45
FNX122	1	TUBE ASS'Y (GS392)	\$73.56
FNX177	1	TUBE ASS'Y (GS397)	\$75.54
FX101	1	FILLER CAP ASS'Y	\$8.00
FX500	1	INTAKE VALVE ASS'Y	\$4.85
FX505-3	1	EXHAUST VALVE ASS'Y	\$3.90
FX800	1	STOCK ASS'Y	\$68.05
G397-011	1	EXHAUST VALVE SPRING	\$.50
G397-017	1	MAIN SPRING	\$.90
HB17-014	1	TRIGGER PIN	\$.50
N603	1	STRIKER GUIDE PIN	\$.50
N605	1	RETAINING CAP SCREW	\$.50
N611-1	1	SAFETY SLIDE	\$1.90
N616-1	1	RTRIGGER SPRING	\$.50
N624	1	SAFETY MOUNT	\$5.26
N625-A	1	TRIGGER SPRING RETAINER	\$3.24
N626-A	1	TRIGGER SPRING PIN	\$.86
N629	1	SOCKET HEAD CAP SCREW	\$.50
N630	1	SPLIT LOCKWASHER	\$.50
N631	2	RETAINING CAP SCREW	\$.50
NB614	1	TRIGGER	\$2.01
NX400-20	1	BOLT ASS'Y (FB9, F9)	*
NX400-22	1	BOLT ASS'Y (G392, GS392)	\$6.39
NX400-77	1	BOLT ASS'Y (G397, GS397)	\$6.72
G397-002	1	FILLER CAP (new number)	\$1.93
G397-012	1	CHAMBER PLUG FACE (new number)	\$.50

each

PRICES AND PARTS ARE SUBJECT TO CHANGE WITHOUT NOTICE

PLEASE ORDER BY PART NUMBER AND DESCRIPTION

CHECK OR MONEY ORDER FOR THE TOTAL PRICE MUST ACCOMPANY THE ORDER

*** NOT AVAILABLE**