

Crosman



45
SA-6
Owner's Manual

MODEL 45BB and SINGLE ACTION 6

Operation and Care

IMPORTANT: Read all instructions carefully before operating your gun. Study gun diagram and become familiar with gun operating parts.

Always Follow These Simple Safety Rules:

1. Treat every gun as if it is a loaded gun.
2. Always keep muzzle of gun pointed in a safe direction.
3. Don't point at anything you don't intend to shoot.
4. Hammer should be in first click position before loading.
5. Be sure of your target and your backstop.
6. Conduct yourself as a true sportsman in using your gun.

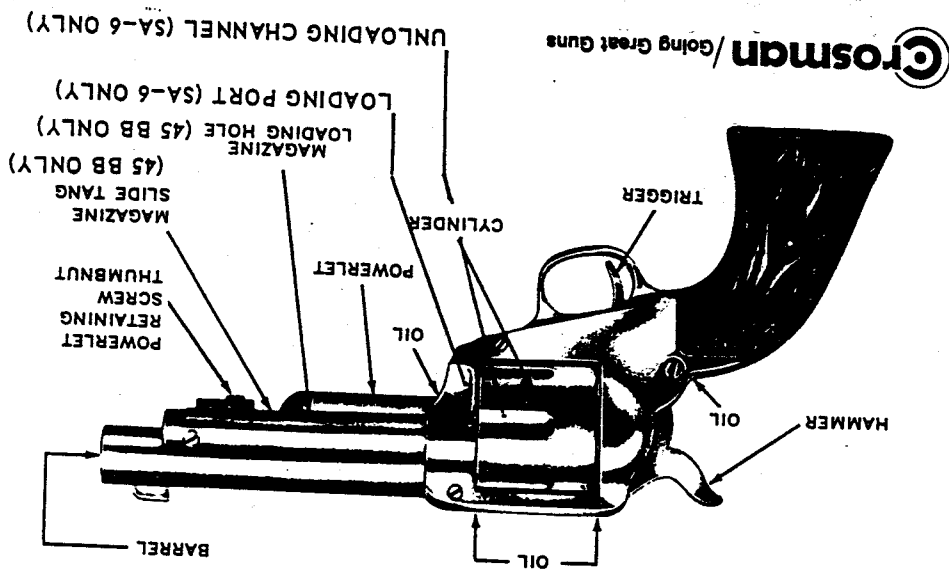

TO CHARGE REVOLVER WITH CO₂:

With pistol pointed in a safe direction, cock hammer as far back as it will go. Fire by squeezing trigger and then push hammer firmly forward with thumb to exhaust remaining CO₂ gas. Cock hammer and shoot one more time to be certain that all gas is exhausted. If not completely exhausted repeat procedure for exhausting gas, as directed above. Unscrew Powerlet retaining screw thumb nut at front of gun until clearance is obtained for Powerlet removal. Grasp Powerlet and pull towards muzzle to remove. Put revolver on safety by cocking hammer to first click, (about 1/4" back). This locks both hammer and trigger, and gun cannot be fired.

Insert Powerlet (CO₂ cylinder) into gun, neck end first. Hold Powerlet straight and with thumb nut at front of gun turn Powerlet retaining screw in until tight against Powerlet. Cock to full position and squeeze trigger to pierce Powerlet. Cock again immediately, wait about 30 seconds, and fire again to be certain Powerlet is pierced and gun is charged with CO₂. Put revolver on safety by cocking hammer to first click. Keep gun in safety position at all times.

When gas pressure appears to be getting low, exhaust remaining gas and insert a new Powerlet. Continuing to shoot with low pressure may cause a Pellet to lodge in barrel.

NOTE: In cold temperatures, velocity and the number of shots decrease. In warm temperatures, velocity and the number of shots increase.

IMPORTANT: The valve in this gun is designed for use with Crosman Powerlets. Other type CO₂ Cylinders may not function properly or may contain impurities harmful to the valve system.

Treat revolver at all times as if it were loaded. As a safety measure, remove all AMMO from revolver before charging with CO₂ gas.

TO LOAD

45BB

Put revolver on safety by cocking hammer to first click (about 1/4" back). Move magazine slide tang, forward and lock into notch. Hold gun upside down. Pour Crosman Super BB's into loading hole until full. Revolve cylinder by hand and hold gun muzzle up at an angle to allow BB's to roll into 6 holes in cylinder. Then pour more Super BB's into loading hole until full. Release magazine slide tang from notch. Maximum load for cylinder and magazine tube is 18 BB's.

SA-6

Use only Crosman .22 Caliber Super Pellets in your Crosman Single Action 6—other makes can cause jamming. Put revolver on safety. Rotate cylinder to align cylinder chambers with loading port. Insert Pellets in cylinder chambers open end down towards hammer.

TO SHOOT

Cock by moving hammer with thumb to full rearward position. This action revolves cylinder placing next round in line with Barrel. At full cock, cylinder is securely locked in position thus preventing misalignment when gun is fired. Take aim, squeeze trigger and shoot. Gun should always be pointed in a safe direction.

TO UNLOAD

45 BB

With revolver pointed in a safe direction, exhaust all gas by firing and pushing hammer firmly forward, with thumb. Move magazine slide tang forward and lock in notch. Hold muzzle straight down. Rotate cylinder slowly stopping at each of 6 clicks. Shake BB's out of magazine tube loading hole as they roll out of cylinder.

Turn cylinder to line Pellet up with loading port. Hold muzzle down, tap gun lightly to eject Pellet from cylinder. (Pellet may also be picked out of cylinder with a pointed instrument.) Revolve cylinder to check each chamber. NOTE: DO NOT attempt to shoot a lodged Pellet out of barrel with another Pellet.

TO REMOVE LODGED AMMO FROM BARREL:

45 BB

Revolve cylinder and stop at one of the audible clicks. Insert a 5/32" diameter rod in muzzle and push defective

BB back into empty cylinder. Remove rod. Rotate cylinder until BB lines up with magazine tube. Hold muzzle down and shake BB out of magazine loading hole. To avoid lodged BB in the barrel, always insist on Crosman Super BB's®—they are precision made.

SA-6

Place hammer in safety position. Turn cylinder to line up unloading channel with the barrel. Insert ramrod (provided) in muzzle and push Pellet back into cylinder unloading channel. Remove rod. Rotate cylinder and remove Pellet from unloading channel.

LUBRICATION:

Proper oiling of guns will eliminate most sealing failures. USE SPARINGLY. Excessive oiling is harmful to gun action. Three or four drops is sufficient for each seal or oiling point. Apply every 250 shots or when parts appear dry. Never use penetrating, detergent or regular gun oils, as they may be harmful to valve washers and seals. USE SPECIAL CROSMAN PELLGUNOIL® FOR BEST RESULTS.

This gun has a newly designed end seal which is made to give positive sealing for a long period of time when used with the Crosman Powerlet. Due to normal wear, the seal may need replacing.

To replace, remove End Seal Retainer 45-51 (pressed in) and End Seal 45-52. Clean foreign material from valve, lubricate new seal with Pellgun oil and press into bottom

PLACE
Necessary
Postage
HERE

TO: CROSMAN ARMS CO., INC.

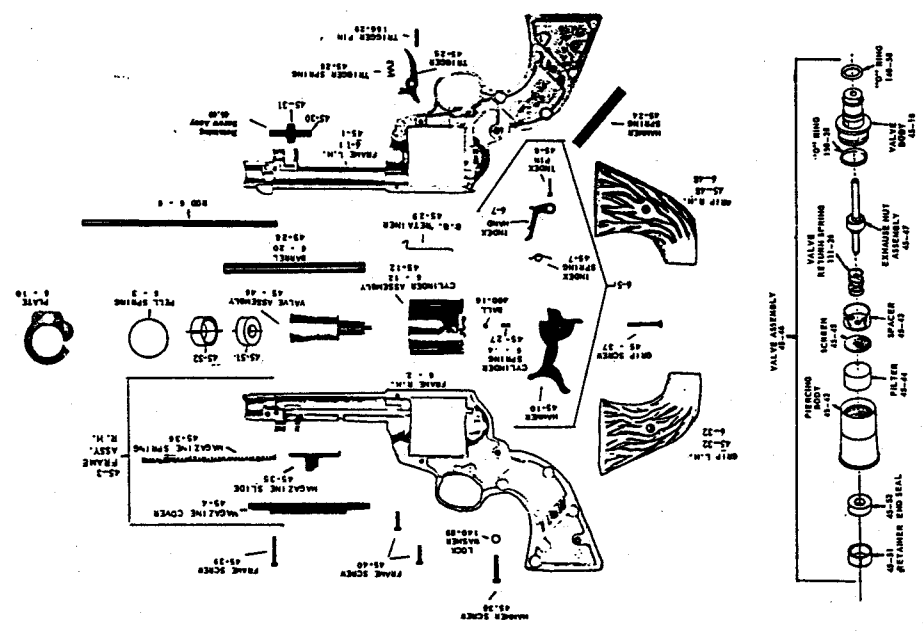

**MODEL 45BB
and
SINGLE ACTION 6**

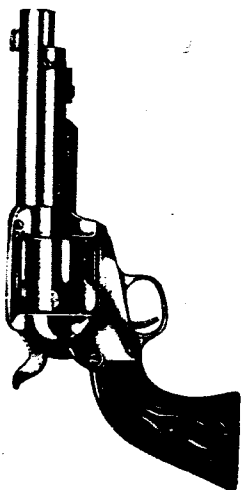

of valve with blunt tool. Press in Retainer.

To clean parts, wipe with cloth and Pellgunoil. Never use gasoline or cleaning fluid, as it may wash into the system and damage valve seals.

REPAIR SERVICE:

It is not necessary for your dealer to replace your gun. Your Crosman gun can be serviced at one of the authorized service stations shown on the attached list. Do not return your gun to the factory. Our service stations are equipped to make warranty repairs on Crosman guns, without returning them to the factory, within the ninety (90) day warranty period. Guarantee Certificate must be properly filled out and accompany your gun in order to qualify for service.

Warranty is void if gun has been disassembled or in the judgement of the service station has been abused or misused. Include a description of the malfunction with gun. Postal regulations prohibit the mailing of pistols by an individual. Request your dealer to mail it for you.

SPECIFICATIONS		
	MODEL 45 BB	MODEL SA-6
Mechanism	Single Action	Single Action
Caliber	BB	.22
Cylinder Cap	6 Crosman Super BB's	Six Crosman Super Pella
Magazine Cap	18 Crosman Super BB's (Including 6 in Cylinder)	None
Weight	34 ozs.	32 ozs.
O/A Length	10 3/8"	10 3/8"
Barrel	Steel Smooth Bore	Steel Button Rifled 10 Lands
Power	One Crosman Giant CO ₂ Powerlet	One Crosman Giant CO ₂ Powerlet
Grips	Staghorn Plastic	Staghorn Plastic
Finish	Blue-Black	Blue-Black

"Hip-Mates"

Left-R-Right Holsters...

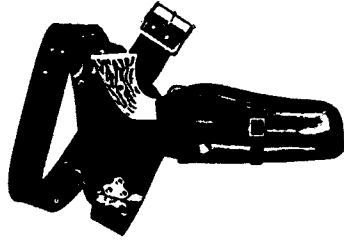

Model HB46 Buscadero Holster for Crosman 45 IloB or SA6 Pistols.

Crosman is first with a complete line of holsters, featuring our new Left-Right design that reverses for use on either hip, for straight or cross-draw action. These exclusive Crosman "Hip-Mates" are made of genuine top grade cowhide with permanent high polish and beautiful workmanship.

IMPORTANT: The guarantee certificate should be properly filled out at time of purchase and must accompany your gun when qualified warranty service is required during the 90-day period. Where the guarantee certificate has been misplaced, a verification (sales slip) from your dealer will suffice.

Warranty

Should this unit become inoperative, due to defective parts or workmanship, Crosman Arms Company fully guarantees it will be repaired to function as originally designed. This guarantee does not imply that worn finish, missing parts and abused components will be replaced/repared at no charge.

ANY OTHER STATEMENT MADE OR IMPLIED REGARDING THE WARRANTY AND NOT INCLUDED HEREON IS INVALID.

GUARANTEE CERTIFICATE IMPORTANT

Keep this certificate. Cut out and take to Crosman Authorized Service Station to qualify for warranty service.

Customer's Name.....

Street.....

Town..... State..... Model.....

Dealer's Name..... Date Purchased.....